

Pool 14 Gal. Beverage Dispenser

Specification Sheet | Models: LD178, LD189, LD190, & LD199

SETTING UP YOUR PRODUCT

* For best results, use filtered or bottled water in dispenser.

- Carefully remove all parts from packaging.
- Make sure you have all parts listed before discarding packaging:
 - Acrylic Lid
 - Acrylic Tank
 - Faucet
 - Bamboo or Metal Base
- Before first use, hand wash all parts by following cleaning instructions attached.
- Assemble faucet by following instructions below.
- Set acrylic tank on base at dispensing location.
- Fill with desired cold beverage and cover with lid.
- It is recommended to fill and empty dispenser at dispensing location because of liquids weight.



LD178: (w/ Bamboo Base)
LD189: (w/ Black Bamboo Base)



LD190: (w/ Stainless Steel Base)
LD199: (w/ Black Metal Base)

FAUCET INSTRUCTIONS

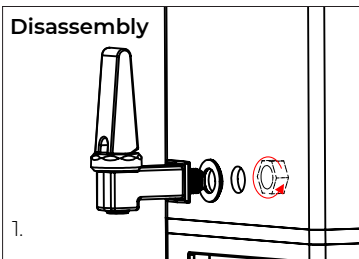
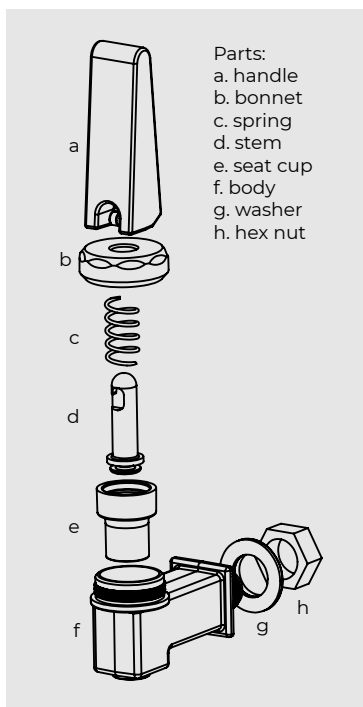

Unscrew hex nut from inside tank. Remove faucet body and silicone washer from front.

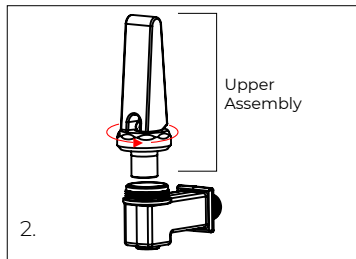

Detach upper assembly from faucet body by unscrewing bonnet.

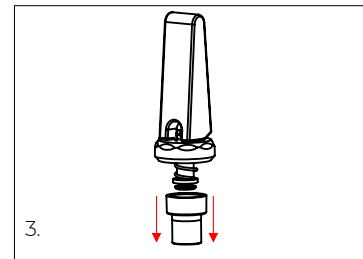

Remove seat cup by pulling down. Follow attached cleaning instructions.

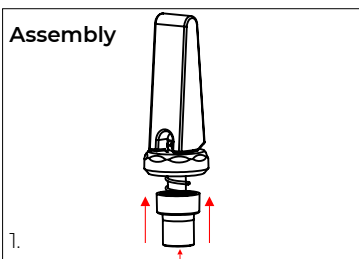

Place the seat cup over stem/spring. Snap seat cup in place by applying direct pressure to the bottom.

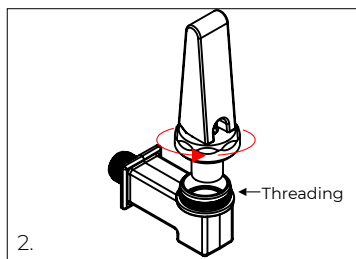

Hand tighten upper assembly/bonnet onto faucet body until you see no more threading.

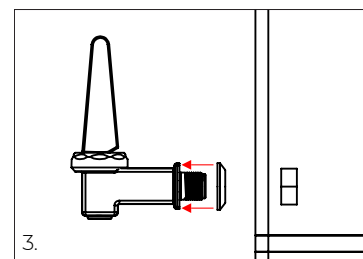

Place washer over threading of faucet, washer should be flush with faucet body. Place faucet on dispenser and secure with hex nut. Hand tighten only!

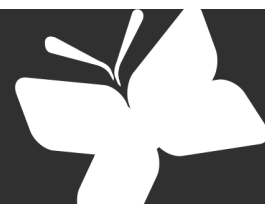

Pool 14 Gal. Beverage Dispenser

Specification Sheet | Models: LD178, LD189, LD190, LD199, LD200



CLEANING & CARE INSTRUCTIONS

- Do not place any part of the beverage dispenser or faucet in the dishwasher or freezer.
- Do not use alcohol, ammonia, or any chemical based cleaners to clean dispenser.
- Do not use abrasive materials such as scrapers or metal based brushes on dispenser/base.

Acrylic Care:

1. Hand wash all parts, including disassembled faucet, with mild soap and warm water after every use.
2. Rinse and dry with soft microfiber cloth.
3. This beverage dispenser is intended to be used with cold liquids only. Never use with hot liquids.

Bamboo & Metal Care:

4. Wipe down with damp microfiber cloth and always wipe dry with a microfiber cloth. Store in a dry, well-ventilated place. A general stainless steel cleaner can be used to polish the metal.

SPECIFICATIONS

LD178 & LD189

Dimensions 18.25 x 18.25 x 25 IN / 46.4 x 6.4 x 63.5 CM

Weight 19.1 lb / 8.7 kg

LD190 & LD199

Dimensions 16.5 x 16.5 x 24.5 IN / 41.9 x 41.9 x 62.3 CM

Weight 18.2 lb / 8.3 kg

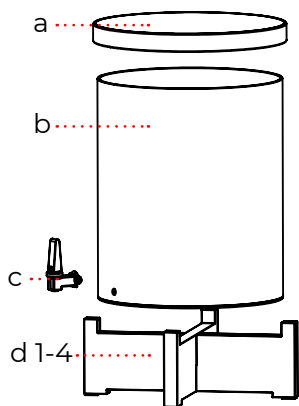
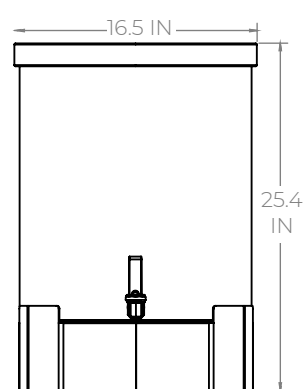
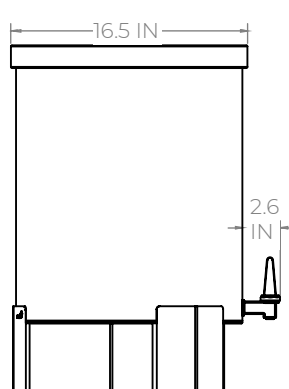
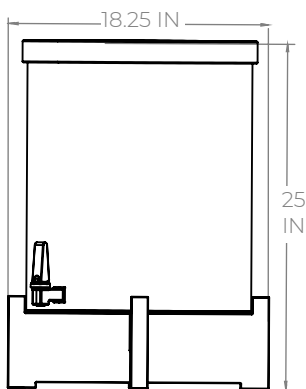
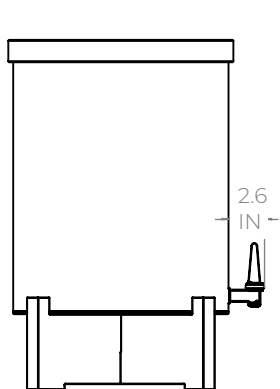

REPLACEMENT PARTS

Item Description	Item Number	Material
a. Lid	LDL178	Acrylic
b. Body	<i>not available</i>	Acrylic
c. Faucet	LDM006	Stainless Steel
d. 1. Bamboo Base	<i>not available</i>	Bamboo
2. Black Bamboo Base	<i>not available</i>	Bamboo, black finish
3. Stainless Steel Base	<i>not available</i>	Stainless Steel, no finish
4. Black Matte Metal Base	<i>not available</i>	Stainless Steel, black finish

NEED ASSISTANCE?

Customer Service Support: **847-763-1215**

Address: **3714 Jarvis Avenue Skokie, IL 60076**

Website: **www.rosseto.com**

