

SQUARE BEVERAGE DISPENSER

①  FOR SHORT & TALL: ITEM # LDL002
FOR LARGE: ITEM # LDL004

②  FOR SHORT & TALL: ITEM # LDF002
FOR LARGE: ITEM # LDF004

③  TANK, BASE, ICE CHAMBER, LID:
FOR SHORT: ITEM # LD106
FOR TALL: ITEM # LD111
FOR LARGE: ITEM # LD128

④  FAUCET:
ITEM # LDM006

Before first use, make sure to hand wash all components of the beverage dispenser in warm soapy water. This dispenser is not dishwasher safe! For best results, use filtered or bottled water in dispenser.

Your Beverage Dispenser includes the following parts:

1. Lid
2. Ice Chamber - This exclusive feature makes refilling your ice easy. When in use, the tray is easily lifted out of the tank using the sturdy handle. This allows you to refill it with ice in one quick action! There is a "fill line" located at the back of the tank itself that conveniently indicates the accepted level for your beverage contents when the ice chamber is in use. By keeping the ice separate, this tool maintains the taste of your beverages while keeping them cool.
3. Tank and Base
4. Faucet

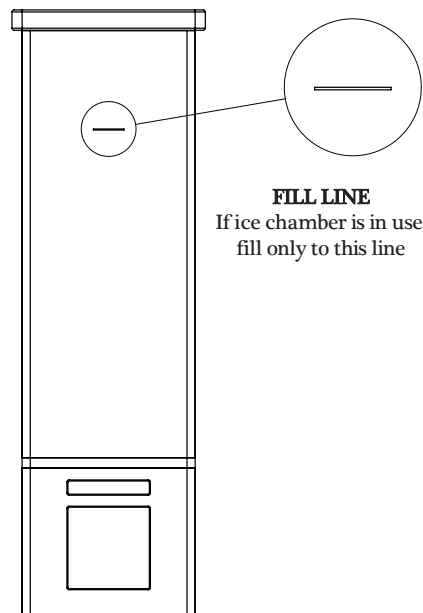

CAPACITY:

Short Square Beverage Dispenser (without Ice Chamber): 1.5 Gallons

Short Square Beverage Dispenser (with Ice Chamber): 1 Gallon

Tall Square Beverage Dispenser (without Ice Chamber): 2.6 Gallons

Tall Square Beverage Dispenser (with Ice Chamber): 2.1 Gallons

Large Square Beverage Dispenser (without Ice Chamber): 4 Gallons

Large Square Beverage Dispenser (with Ice Chamber): 3.2 Gallons

OPTIONAL ACCESSORIES:

BASE COVERS:

The base of the tank easily fits into our exclusive stainless steel and bamboo base covers. Note: Please be sure to face the Rosseto logo toward the front to ensure a proper fit. The grooves along either side of the base covers should match up exactly with the same grooves on the tank.

DRIP TRAY:

Made of stainless steel and acrylic parts, the drip tray complements the beverage dispenser both stylistically and operationally. Placed directly under the beverage dispenser faucet, the drip tray serves as a catch basin for minor spills.

Square Drip Tray
ITEM #: LD108

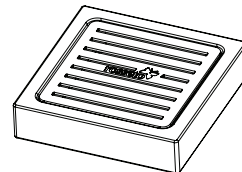

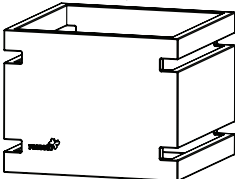
NATURAL BAMBOO
SMALL: ITEM # LD110
PART OF 1-GAL SET # LD116 / 2-GAL SET # LD112
LARGE: ITEM # LD129, PART OF 4-GAL SET # LD131

BLACK BAMBOO
ITEM # LD120
PART OF 1-GAL SET # LD122 / 2-GAL SET # LD121

PYRAMID STAINLESS STEEL
SMALL: ITEM # LD137
PART OF 1-GAL SET # LD141 & 2-GAL SET # LD143
LARGE: ITEM # LD135
PART OF 4-GAL SET # LD139

PYRAMID BLACK MATTE
SMALL: ITEM # LD138
PART OF 1-GAL SET # LD142 & 2-GAL SET # LD144
LARGE: ITEM # LD136
PART OF 4-GAL SET # LD140

NEED ASSISTANCE?

Please contact our customer support at (847)763-1215 and we'll be happy to assist with any assembly questions, comments or concerns.

ROSSETO® 3714 Jarvis Ave. Skokie, IL 60076

Visit our website at: www.rosseto.com

CARE INSTRUCTIONS:

HOW TO CARE FOR YOUR ROSSETO BEVERAGE DISPENSER

- **Do not place any part of your beverage dispenser in the freezer or dishwasher**
- **Hand wash all acrylic parts with warm soapy water. Rinse and dry with soft cloth for best results**
- Do not use alcohol, ammonia, or any chemical based cleaners to clean dispenser
- Do not use abrasive materials such as scrapers or metal based brushes on dispenser
- **ONLY** use this product for cold liquids

BAMBOO:

Stow your Bamboo Base Cover in a dry and ventilated place. Keep your Bamboo Base Cover away from heat and direct sunlight.

STAINLESS STEEL:

Handwash your Stainless Steel Drip Tray Top with a damp washcloth. Use any glass surface or stainless steel cleaning product to remove surface stains.

To keep it protected, stow your Stainless Steel Base Cover in the box it came in.

SAMPLE SETUP

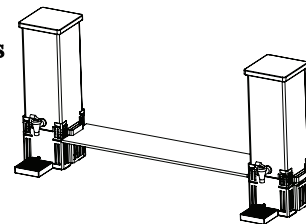

DO NOT USE HOT LIQUIDS WITH THIS BEVERAGE DISPENSER

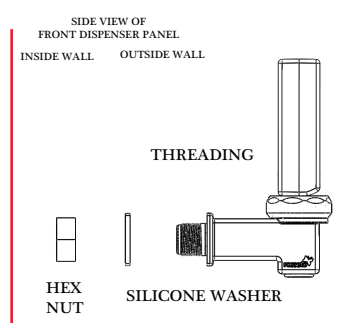

FIGURE A-1

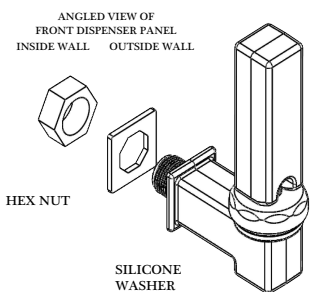

FIGURE A-2

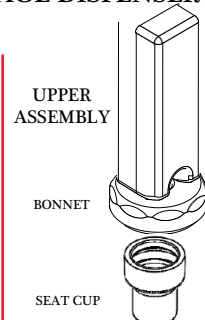

FIGURE C

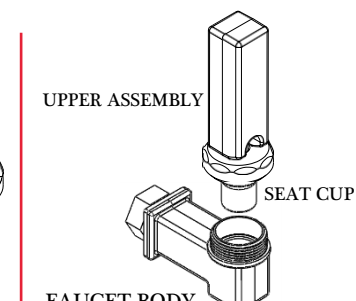
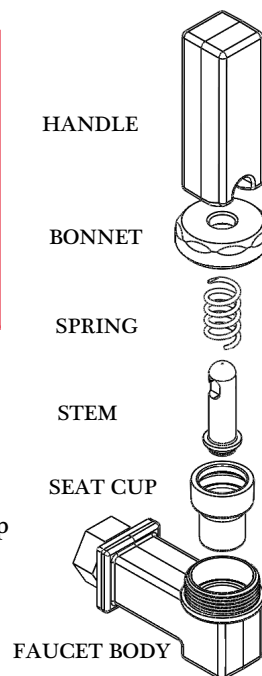

FIGURE D



DISASSEMBLY

1. Detach faucet from dispenser by unscrewing hex nut from inside tank (Figures A-1 & A-2)
2. Pull out faucet body and silicone washer from front, retrieve hex nut from inside tank
3. Detach upper assembly from faucet body by unscrewing bonnet. Once the upper assembly is separated from the faucet body, pull seat cup away from handle/bonnet (Figure D). NOTE: If seat cup remains in faucet body after it was detached from the upper assembly, remove seat cup from faucet body
4. Clean all parts in warm soapy water.

ASSEMBLY

1. Place seat cup over stem/spring on upper assembly. Securely lock the stem into the base of the seat cup. You will know when the seat cup is securely locked in place when it will not detach from stem easily.
2. Hand tighten upper assembly/bonnet onto faucet body. You will know that the bonnet is properly installed if no threading is seen on the faucet body.
3. Install the faucet body onto body of dispenser. Place silicone washer over threading of faucet body **MAKING SURE SILICONE WASHER IS FLUSH WITH BACK OF FAUCET BODY** (Figures A-1 & A-2)
4. With one hand, place threading of faucet body through hole in front of the dispenser. With the other hand, screw the hex nut onto the faucet from the inside of dispenser to secure. Hand tighten only
5. Fill container at location of dispensing. Drain dispenser at the end of the day before moving. If full, 2 people are required to move dispenser

Rosseto cares about keeping your product protected and keeping the environment clean! That's why we use recyclable premium molded foam packaging made from polyisocyanate and combination polyether (PU). If you are not using it to stow your Beverage Dispenser, please make sure to recycle.

For a list of Polyurethane Recycling Companies near you, please visit:

<http://www.recyclingplasticwaste.com/recyclers/usa/polyurethane/>

