

Mosaic 3 Gal. Coffee Urn

Instruction Sheet | Models: LD192, LD201, & LD206

SETTING UP YOUR PRODUCT

- Carefully remove all parts from packaging and poly bags.
- Make sure you have all parts listed before discarding package:
 - Lid
 - Body
 - Faucet
 - Stainless Steel, Black, or Bronze Base
 - Fuel Holder
- Hand wash all parts before first use by following cleaning instructions attached.
- Assemble faucet by following instructions below.
- Fill with desired hot beverage. It is recommended to fill urn at dispensing location for safety.
- Place sterno (not included) in fuel holder and light flame.
- Place fuel holder in the urn base on the tray to keep beverage hot.
- Be cautious when using the urn as components including base, knobs, and lid become hot. Always transport the urn by using hot pads and never with bare hands.**



FAUCET INSTRUCTIONS

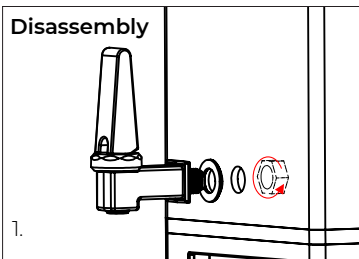
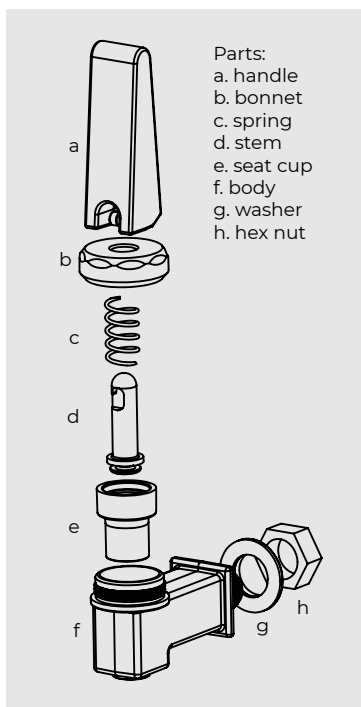

1. Unscrew hex nut from inside tank. Remove faucet body and silicone washer from front.

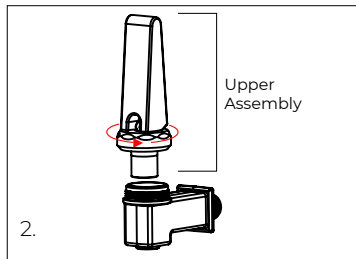

2. Detach upper assembly from faucet body by unscrewing bonnet.

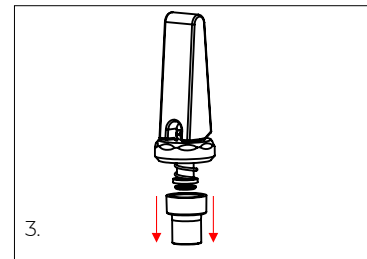

3. Remove seat cup by pulling down. Follow attached cleaning instructions.

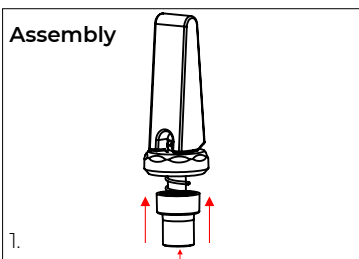

1. Place the seat cup over stem/spring. Snap seat cup in place by applying direct pressure to the bottom.

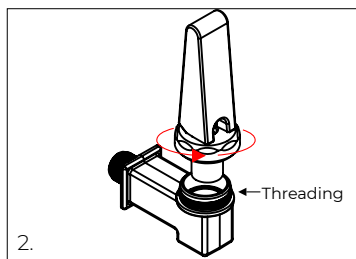

2. Hand tighten upper assembly/bonnet onto faucet body until you see no more threading.

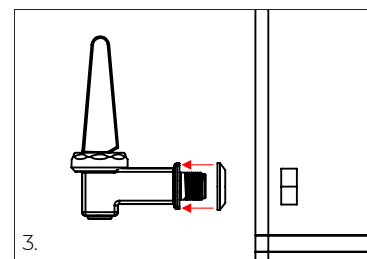

3. Place washer over threading of faucet, washer should be flush with faucet body. Place faucet on dispenser and secure with hex nut. Hand tighten only!

NEED ASSISTANCE?

Customer Service Support: **847-763-1215**

Address: **3714 Jarvis Avenue Skokie, IL 60076**

Website: **www.rosseto.com**



Mosaic 3 Gal. Coffee Urn

Specification Sheet | Models: LD192, LD201, LD202, & LD206

CLEANING & CARE INSTRUCTIONS

1. Hand wash all parts, including disassembled faucet, with mild soap and warm water after every use.
2. Rinse and dry with soft microfiber cloth.
3. Do not place any part of the beverage dispenser or faucet in the dishwasher or freezer.
4. Do not use alcohol, ammonia, or any chemical based cleaners to clean dispenser.
5. Do not use abrasive materials such as scrapers or metal based brushes on dispenser.



SPECIFICATIONS

Capacity 2.9 Gallons / 11 Liters

LD192, LD201, LD202

Dimensions 11 x 9 x 24.4 IN / 27.9 x 22.9 x 70 CM

Weight 8.7 lb / 3.9 kg

LD206

Dimensions 11 x 9 x 18.75 IN / 27.9 x 22.9 x 47.6 CM

Weight 5.6 lb / 2.5 kg

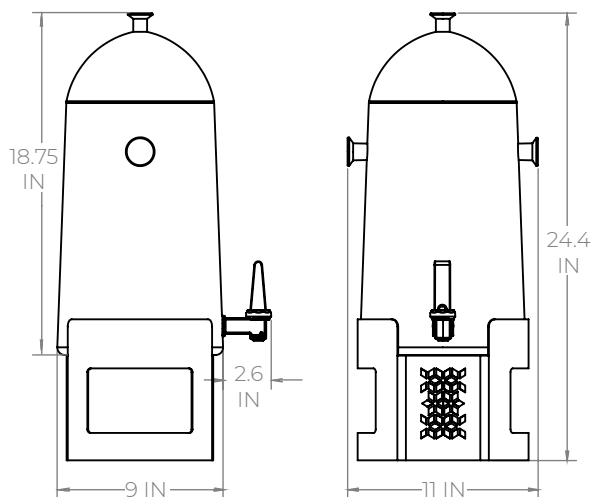

REPLACEMENT PARTS

Item Description	Item Number	Material
a. Lid	LDL021	Stainless Steel
b. Body	<i>not available</i>	Stainless Steel
c. Faucet	LDM006	Stainless Steel
d. 1. Stainless Steel Base	<i>not available</i>	Stainless Steel, no finish
2. Black Matte Base	<i>not available</i>	Stainless Steel, black finish
3. Bronze Base	<i>not available</i>	Stainless Steel, bronze finish
e. Fuel Holder	LD194	Stainless Steel

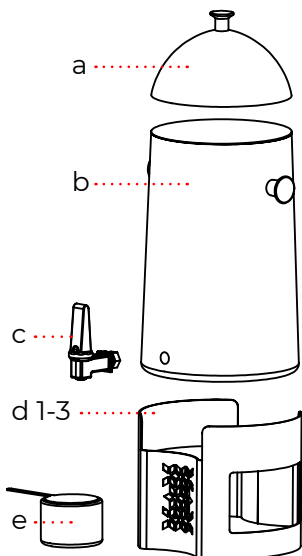

NEED ASSISTANCE?

Customer Service Support: **847-763-1215**

Address: **3714 Jarvis Avenue Skokie, IL 60076**

Website: **www.rosseto.com**

R1 10012019

